



21 Sheldon Square , London, W2 6DS Offers in the region of £1,200,000

Nestled in the vibrant area of Sheldon Square, London, this charming apartment offers a modern living experience in a prime location. Spanning an impressive 990 square feet, the property provides ample space for comfortable living. Constructed in 2004, it boasts contemporary design elements that cater to the needs of today's discerning homeowner.

The apartment is thoughtfully designed to maximise natural light, creating a warm and inviting atmosphere throughout. With its modern finishes and well-planned layout, this property is perfect for both families and professionals seeking a stylish abode in the heart of the city.

Sheldon Square is known for its excellent amenities and convenient transport links, making it an ideal choice for those who wish to enjoy the best of London living. Whether you are looking to explore the local parks, dine at nearby restaurants, or take advantage of the vibrant cultural scene, this location has it all.

This property represents a fantastic opportunity for anyone looking to invest in a modern home in one of London's most sought-after areas. Don't miss your chance to make this delightful house your new home.

Viewing

Please contact us on 020 3198 4517 if you wish to arrange a viewing appointment for this property or require further information.



Floor Plan

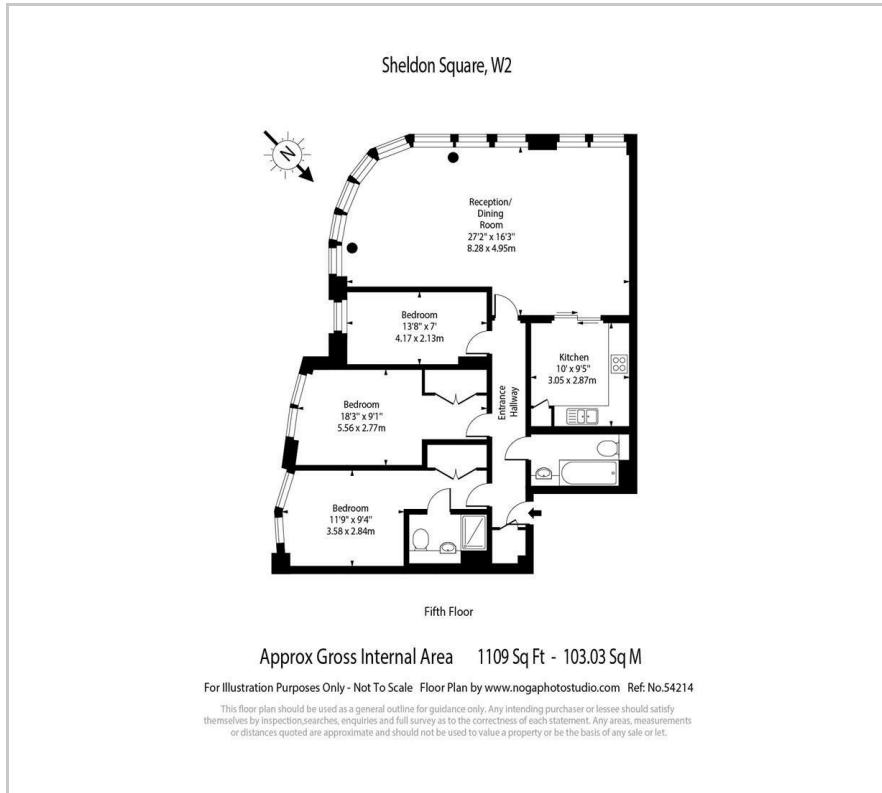

Area Map



Energy Efficiency Graph

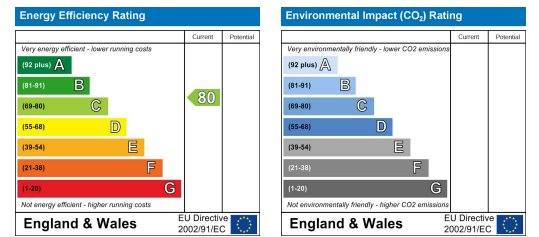

These particulars, whilst believed to be accurate are set out as a general outline only for guidance and do not constitute any part of an offer or contract. Intending purchasers should not rely on them as statements of representation of fact, but must satisfy themselves by inspection or otherwise as to their accuracy. No person in this firm's employment has the authority to make or give any representation or warranty in respect of the property.